

AT5 Pitch Aluminum												
Standard Belt Widths: 10mm, 16mm, 25mm							10 mm Belt		16 mm Belt		25 mm Belt	
Part Number	Type	Teeth	De	Df	Dm	d	F	L	F	L	F	L
AT5/12-2	6F	12	17.85	23.0	11	-	15	21	21	27	30	36
AT5/14-2	6F	14	21.05	25.0	14	-	15	21	21	27	30	36
AT5/15-2	6F	15	22.65	28.0	16	6	15	21	21	27	30	36
AT5/16-2	6F	16	24.20	32.0	18	6	15	21	21	27	30	36
AT5/18-2	6F	18	27.40	32.0	20	6	15	21	21	27	30	36
AT5/19-2	6F	19	29.00	36.0	22	6	15	21	21	27	30	36
AT5/20-2	6F	20	30.60	36.0	23	6	15	21	21	27	30	36
AT5/22-2	6F	22	33.85	38.0	24	6	15	21	21	27	30	36
AT5/24-2	6F	24	37.00	42.0	26	8	15	21	21	27	30	36
AT5/25-2	6F	25	38.60	44.0	26	8	15	21	21	27	30	36
AT5/26-2	6F	26	40.20	44.0	26	8	15	21	21	27	30	36
AT5/27-2	6F	27	41.80	48.0	30	8	15	21	21	27	30	36
AT5/28-2	6F	28	43.35	48.0	32	8	15	21	21	27	30	36
AT5/30-2	6F	30	46.55	51.0	34	8	15	21	21	27	30	36
AT5/32-2	6F	32	49.70	54.0	38	8	15	21	21	27	30	36
AT5/36-2	6F	36	56.05	64.0	38	8	15	21	21	27	30	36
AT5/40-2	6F	40	62.45	66.5	40	8	15	21	21	27	30	36
AT5/42-2	6F	42	65.60	70.0	40	8	15	21	21	27	30	36
AT5/44-2	6	44	68.80	-	45	8	15	21	21	27	30	36
AT5/48-2	6	48	75.15	-	50	8	15	21	21	27	30	36
AT5/60-2	6	60	94.25	-	65	8	15	21	21	27	30	36

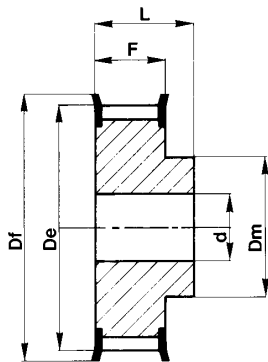

Type 6F

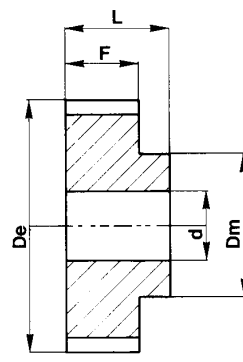

Type 6